



SprutCAM

success story of

Torres-Pamer, S.L.

Torres Pamer SL is a family-owned company created in 1978, specialized in the manufacture of dies and verification tools for the auxiliary industry of the automotive industry.

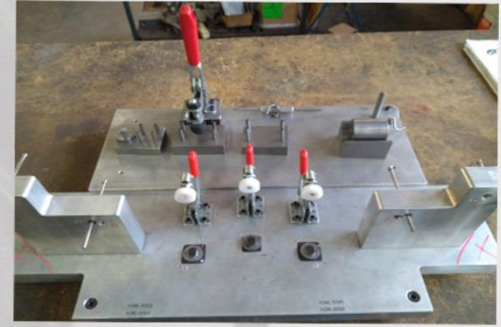
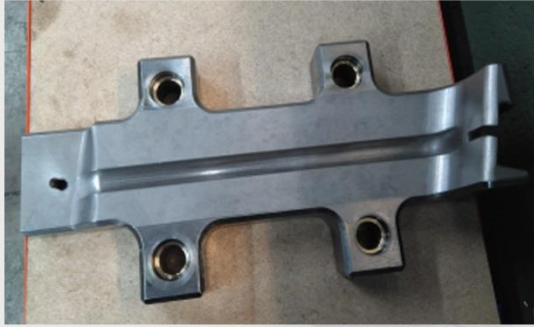

They are experienced users in the use of CAD / CAM systems and due to changes in their production methods decided to pass parts of the manufacturing process made in technical office to the machining plant. In that process of change they proposed to replace one of their CAM systems with one more adapted to the manufacturing process performed by the CNC machine operators.

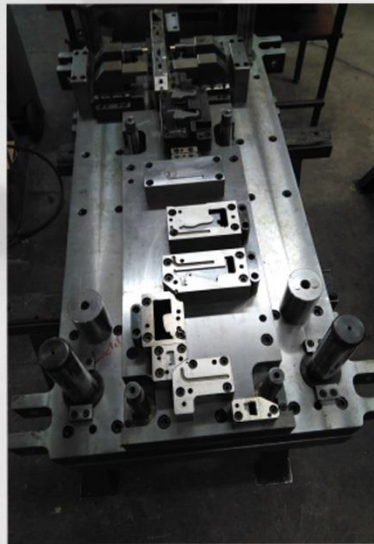

In the process of change they evaluated different systems but decided by Sprutcam for its ease of use and fast adaptation to the operation of the program.

In the words of the head of the technical office "We were surprised with the ease that has been adapted in the production plant to the new system, now in the office we can devote to other tasks in our production system."